

# Noble Driller

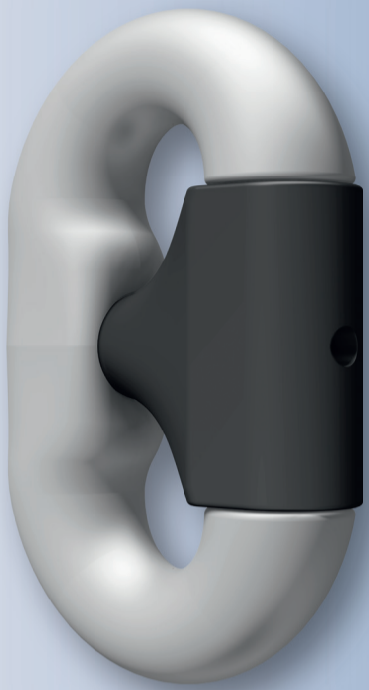

DCCL 95 mm



Nautilus Swivel 1000 to



Mambo Shackle 900



**Rig Type:** Semisub  
**Semisub Generation:** 2  
**Rig Design:** Aker H-3 twin hull  
S1289 column stabilized  
**Rated Water Depth:** 5,000 ft  
**Drilling Depth:** 30,000 ft

The strongest link  
in your supply chain. FEUBO.

